



Model BVECXL

Full Port Bronze Ball Valve with Integral Thermal Expansion Relief Valve

Application

The ZURN WILKINS Model BVECXL is designed for residential water heater applications where a water heater shut-off and thermal expansion relief valve are combined to provide protection from thermal expansion. Ideal where lead-free* valves are required.

Standards Compliance

- IAPMO® Listed
- Certified to NSF/ANSI 372* by IAPMO R&T
*(0.25% MAX. WEIGHTED AVERAGE LEAD CONTENT)



Materials

FNPT valve Body	Low Lead Cast Bronze ASTM B 584
Copper sweat Body	Low Lead Forged Brass
PEX Body	
Ball	Chrome plated Low Lead Brass
Stem	Brass ASTM B 16
Seats & Stem packing	TFE virgin Teflon ®
Thrust washer	TFE virgin Teflon ®
Handle & nut	Stainless steel
Relief valve body	Low Lead Forged Brass
Relief valve spring	Stainless steel, 302 Series
Relief valve seat washer	Buna Nitrile (FDA approved)
Relief valve plunger	Brass ASTM B 16 & screw

Options

- 80 - with 80 psi relief setting
- 100 - with 100 psi relief setting
- 125 - with 125 psi relief setting
- BF - 3/8" hose barb drain fitting
- CF - 3/8" hose compression fitting
- PEX - 1/2" PEX drain fitting

Features

Sizes:	3/4", 1"
Pressure rating	400psi WOG
Temperature rating	180°F
Threaded Connections	ANSI B1.20.1 Class 125

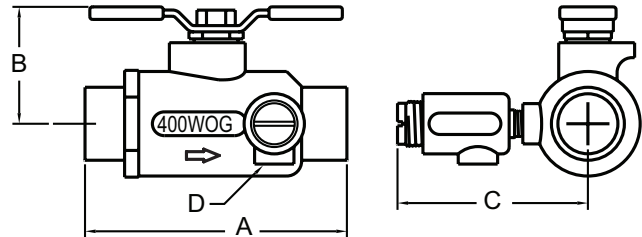

Dimensions & Weights (do not include packaging)

MODEL	SIZE		CONNECTION	DIMENSIONS (approximate)						WEIGHT		
				A		B		C				D
	in.	mm		in.	mm	in.	mm	in.	mm	lbs.	kg	
34-BVECXLC	3/4	20	SWEAT	3 15/16	100	1 15/16	49	2 13/16	71	1/8" FNPT	1 3/8	0.6
34-BVECXL	3/4	20	FNPT	2 3/4	70	1 5/8	41	2 13/16	71	1/8" FNPT	1	0.5
1-BVECXL	1	25	FNPT	3 1/4	83	1 15/16	49	2 15/16	75	1/8" FNPT	1 1/2	0.7
34-BVECXLPEX	3/4	20	PEX	3 3/16	81	1 1/2	38	2 1/2	64	1/8" FNPT	1	0.5

Typical Installation

